

Light beam direction

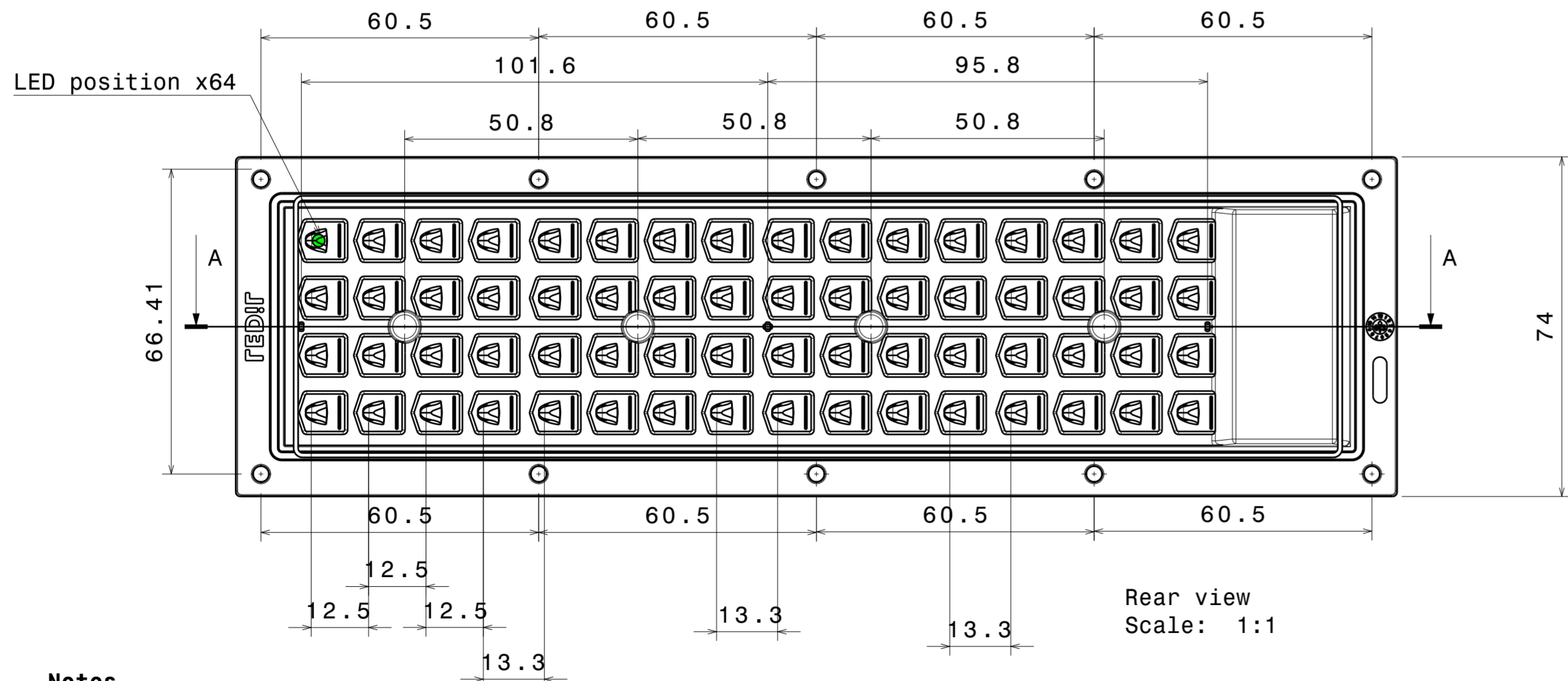
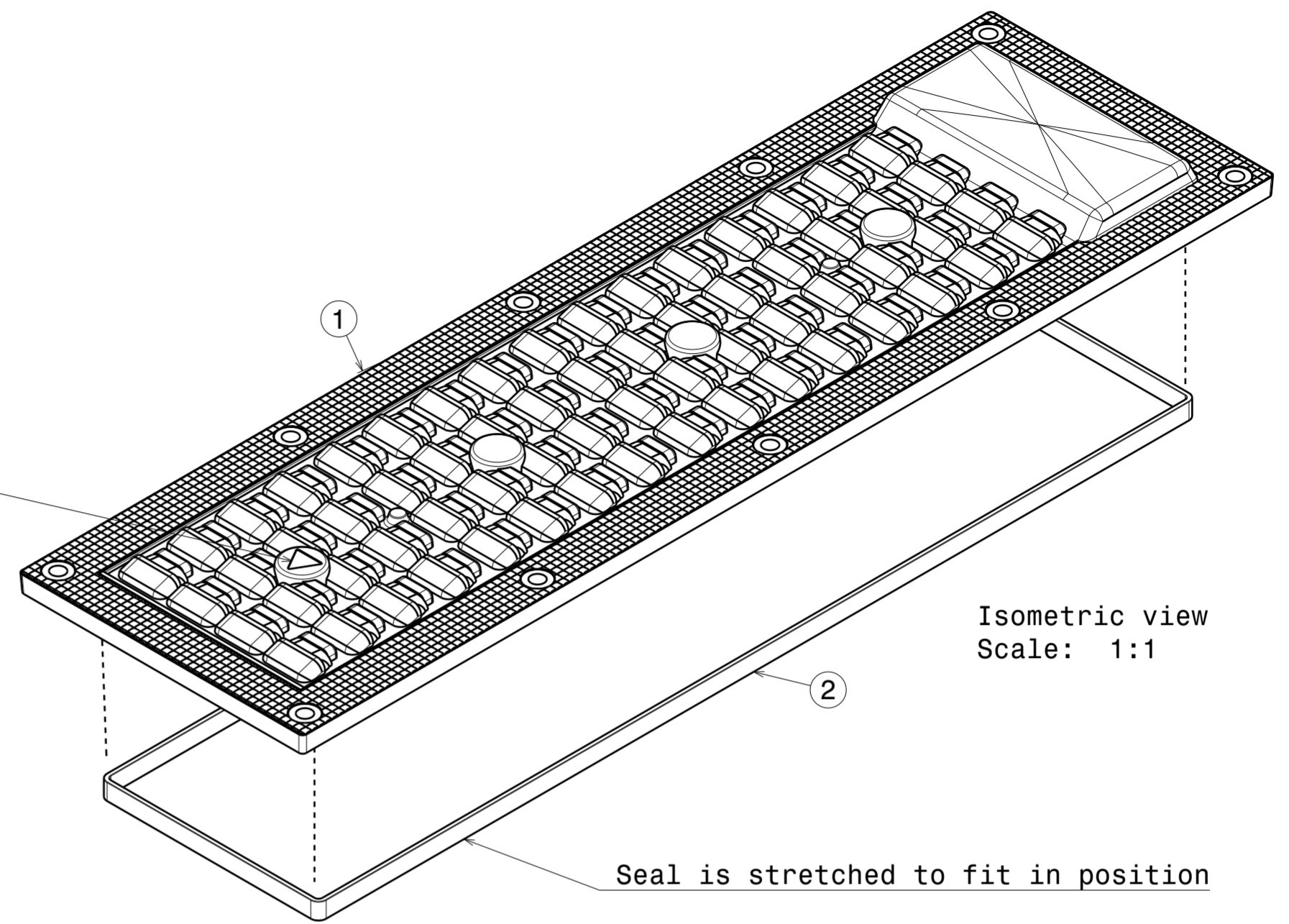

CS17643\_STRADELLA-IP-64-T4-B-PC

**COMPONENTS**

INDEX	PART	TYPE	MATERIAL	COLOR / COATING
1	C17641_STRADELLA-IP-64-T4-B-PC		PC	
2	C17215_STRADELLA-IP-64-SEAL		Silicone	

**MECHANICAL DRAWING**

PRODUCT  
**STRADELLA**

Plastic moulding general tolerances according to DIN 16901-130 and applies if not otherwise shown in the drawing. Silicone moulding general tolerances according to ISO 3302-1 Class M3 and applies if not otherwise shown in the drawing.

FIRST ANGLE PROJECTION:

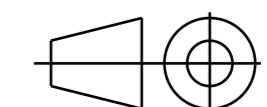

**LEDiL®**

This drawing is the property of LEDiL Oy. It may not be copied or otherwise distributed without prior written permission from LEDiL Oy.

SCALE 1:1

WEIGHT -

A2 SHEET 1/1

**Notes**

- PCB or heatsink level.
- LED location
- Ensure LED fitting from a product specific 3D model available from [www.ledil.com](http://www.ledil.com)
- For more details about installation please see LEDiL Installation Guide on [www.ledil.com](http://www.ledil.com)